



JACOBS

桜
花
見

HANAMI LINE



A PROJECT OF THE
SACRAMENTO
TREE FOUNDATION

DESIGN DEVELOPMENT SUMMARY

NOVEMBER 1, 2021

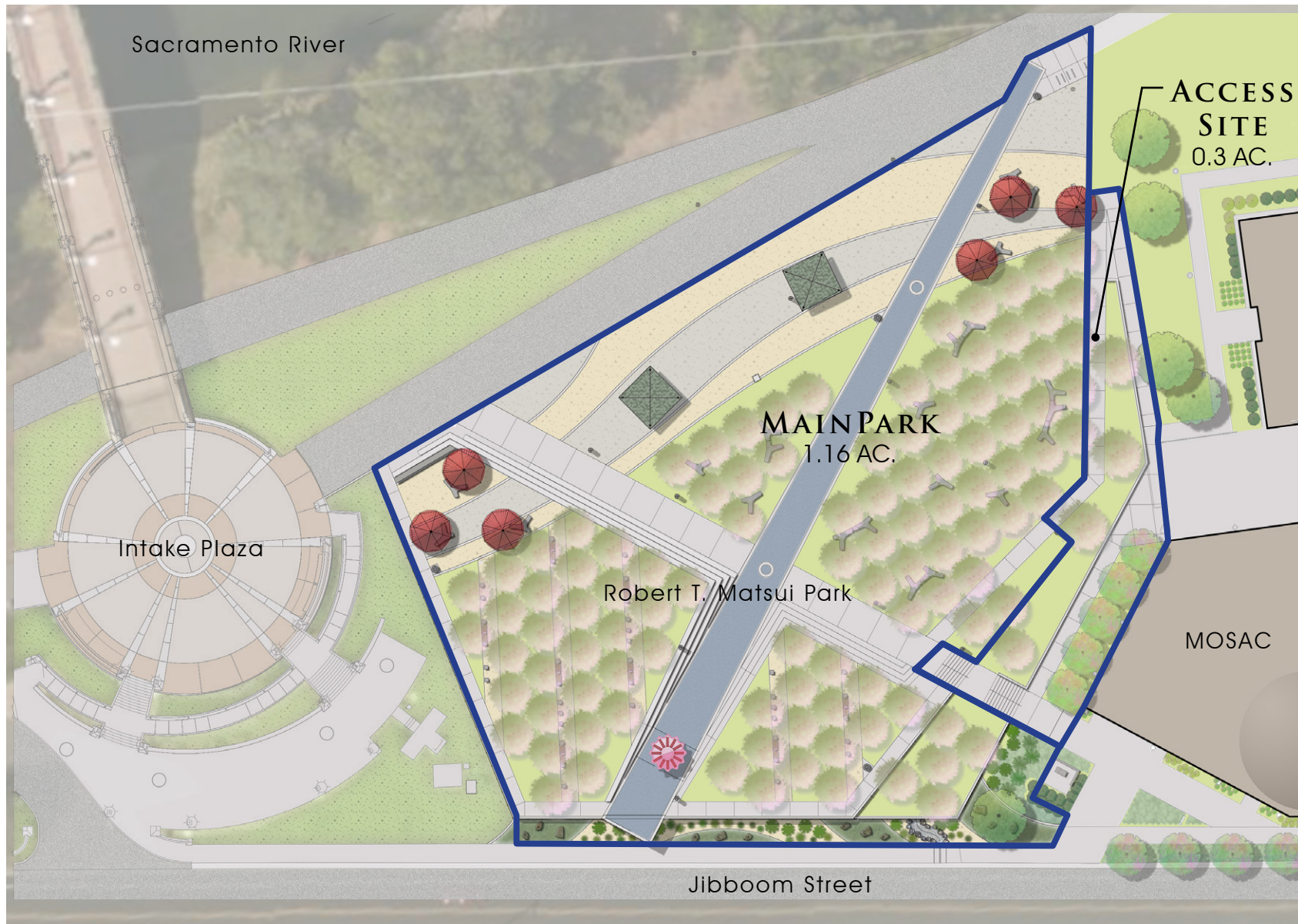

The total project is 1.46 acres and is organized into two areas for purposes of funding, phasing and implementation. Each area is defined within this document with emphasis on the park site.



The access site links pedestrians between the park and the museum. It is a separate area due to funding sources and unique construction procurement requirements associated with those sources. The site includes retaining walls, stairs, ramps and associated planting.



The Robert T. Matsui Park site is the primary focus of this design development document and is described in more detail starting on page 6.

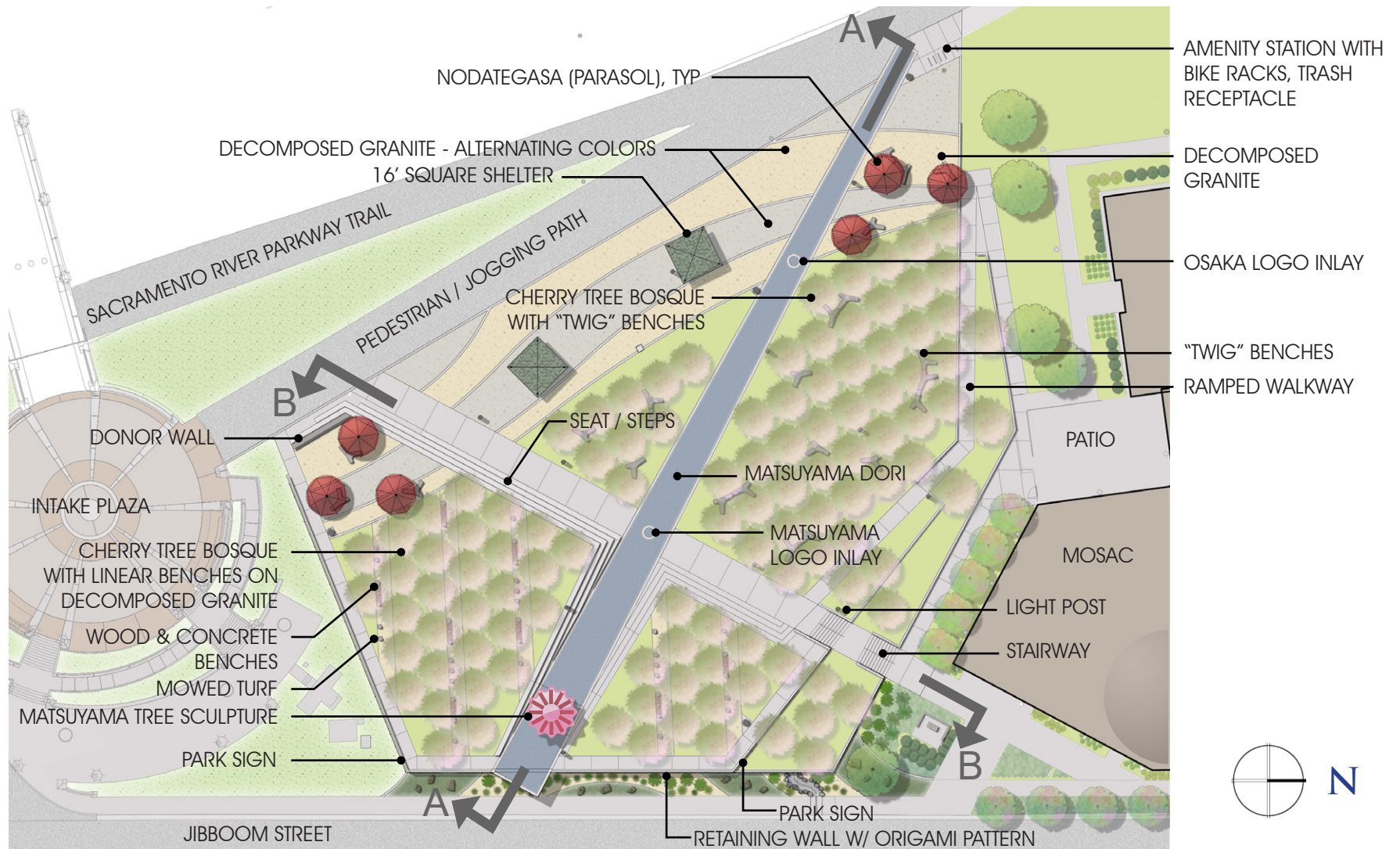

The park site geometries are inspired by the ancient Japanese art of origami. The cherry trees are planted in geometric patterns using triangulated spacing that emulates the fruit tree orchards in California that many Japanese immigrants helped establish. The easterly tree bosque has an urban quality with linear ground plane patterns and seating elements. The westerly tree bosque has a casual quality with mowed grass and organic seating elements. The park is bifurcated with the Matsuyama Dori linking the waterfront to the tree sculpture along Jibboom Street. This walkway is strategically aligned with our sister city in Matsuyama, Japan and paved with a blue Seigaiha pattern.



Easterly Tree Bosque Perspective

The Matsuyama Dori is a key design element within the park that is aligned with our sister city in Japan and also connects the cherry tree sculpture to the waterfront. The walkway has blue pavers that emulate the traditional Japanese Seigaiha pattern used for many centuries in textiles, architecture, pottery and art.



Jibboom Street Perspective

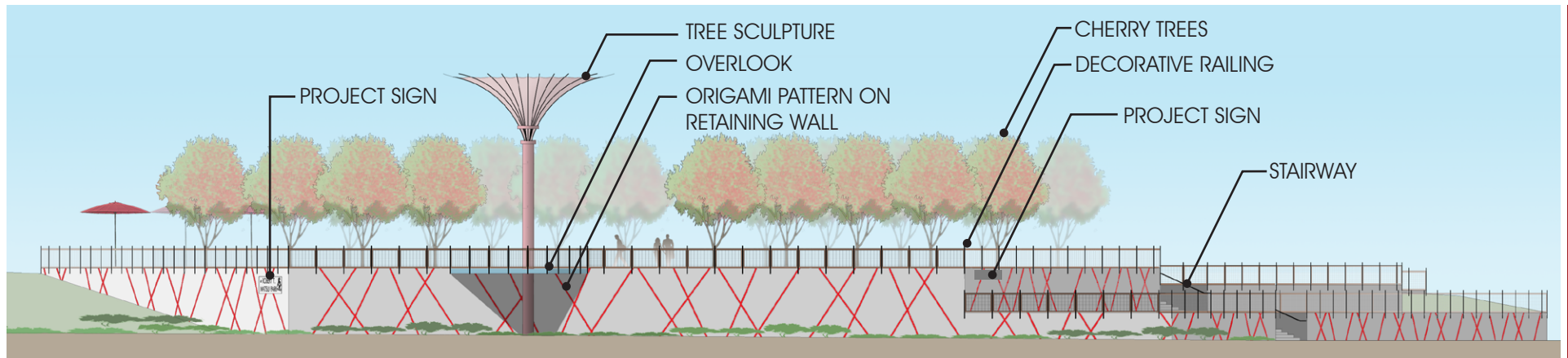

Jibboom Street Elevation

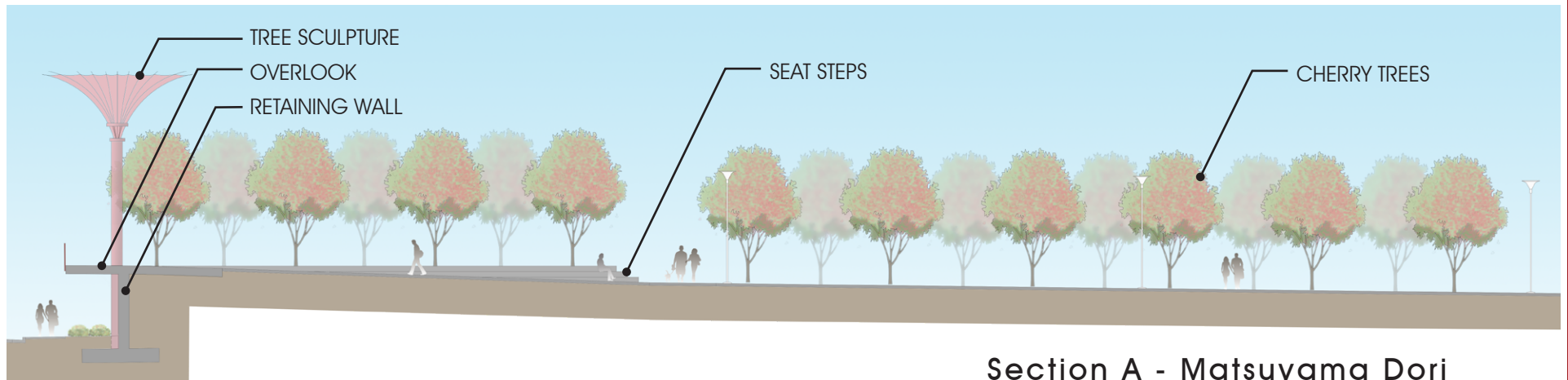

Section A - Matsuyama Dori

The park site slopes up from the existing levee so that views to the river are maximized. This is accomplished through a raised cherry tree planter with terraced seating steps and approximately 11' retaining wall along Jibboom Street. The retaining wall has a formliner finish and origami patterns defined with reveals that are colored red. This pattern compliments the vector lines on the adjacent museum building. The planned art sculpture will reflect the Hanami experience and will act as an iconic focal point in the park, attracting visitors near and far for a memorable photo opportunity.

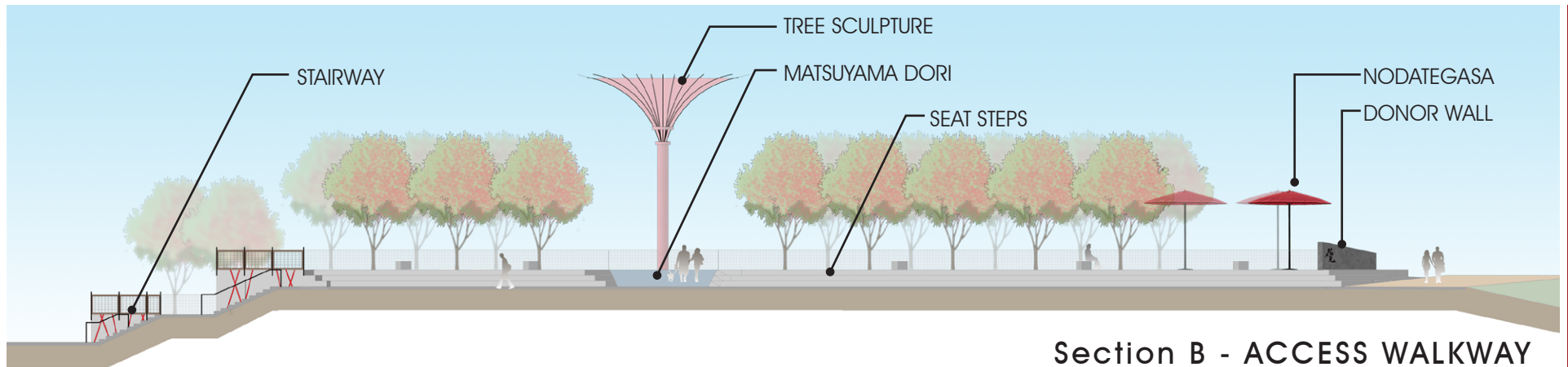

Section B - ACCESS WALKWAY

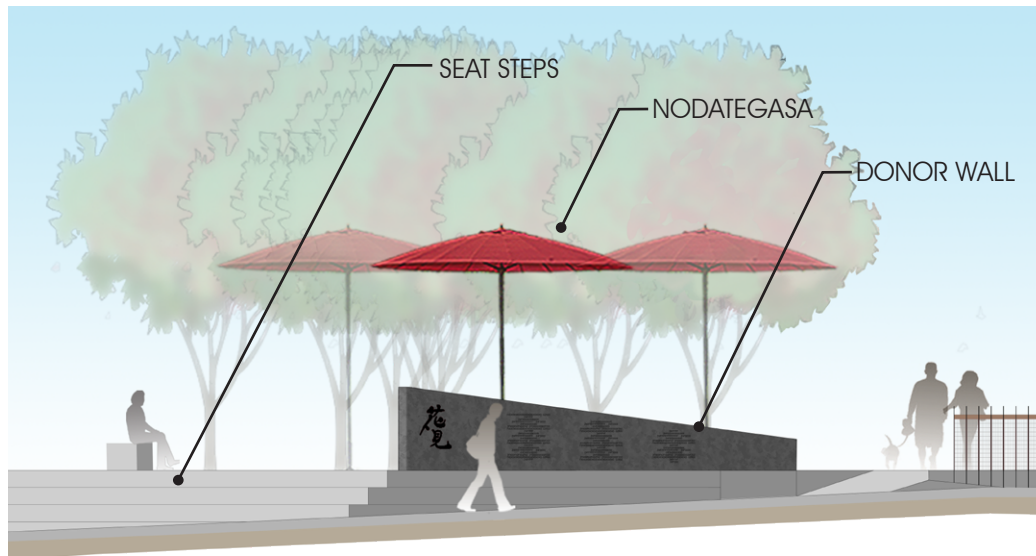

Donor Wall



Seat Steps

The stairway and ramps provide access to the park site from the museum along Jibboom Street. The donor wall is engraved stone and will remind visitors of the generosity of those who helped build the park for generations to come. Terraced seat steps offer places to mingle and view the river.



Pink Flair Cherry Tree

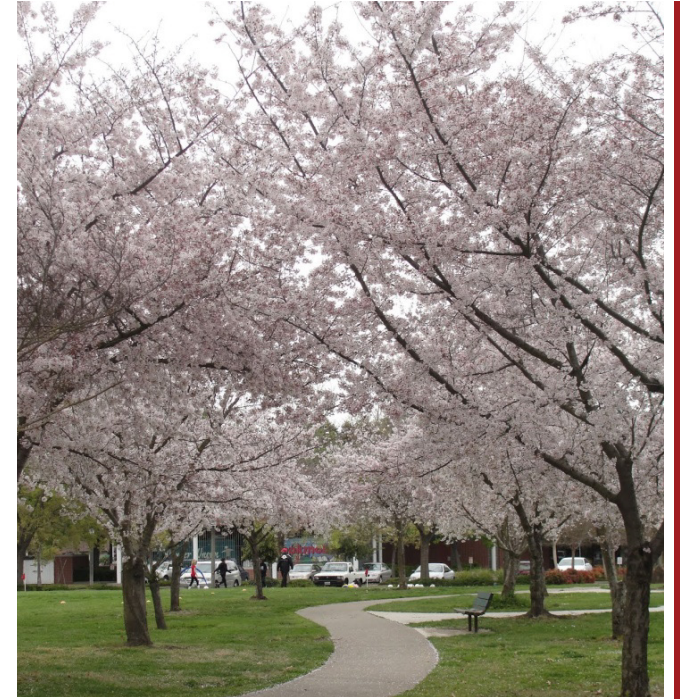

Yoshino Cherry Tree



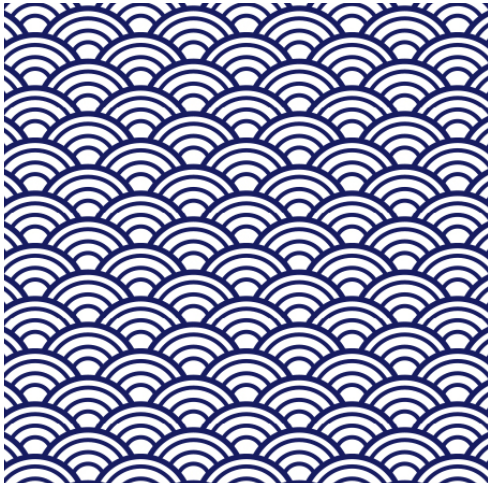

Seigaiha Wave
Pattern Examples



Matsuyama Dori Perspective



Matsuyama Logo Inlay



Osaka Logo Inlay



Sample Manhole Covers

Two logo inlays will be placed in the Matsuyama Dori - one for the prefecture of Osaka and one for the city of Matsuyama. These inlays are inspired by the Japanese tradition of decorative manhole covers that are used in urban areas throughout Japan. The manholes will be based upon a specific design from each of these locations and cast into the walkway flush with the finish surface.



Easterly Tree Bosque

The bench design within the easterly tree bosque is unique to this park site. The wood seating element is harvested from the Sacramento urban forest and milled by the Sacramento Tree Foundation through their Urban Wood Rescue program. The wood slabs are finished on the top and bottom but retain the live edge to preserve the natural bark. The concrete supports are notched to receive the wood slab and the slab is easily replaced when aging or vandalism occurs. The supports are also featured as cube seating elements within the park offering a variety of options for seating and table top surfaces.

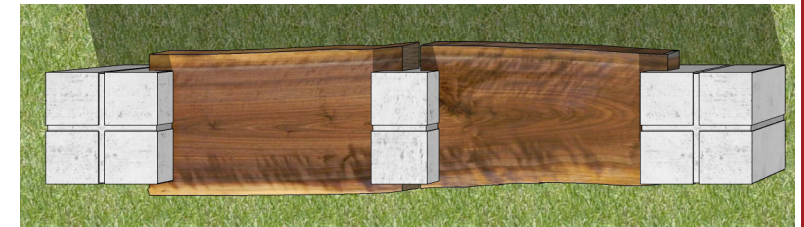

Plan View

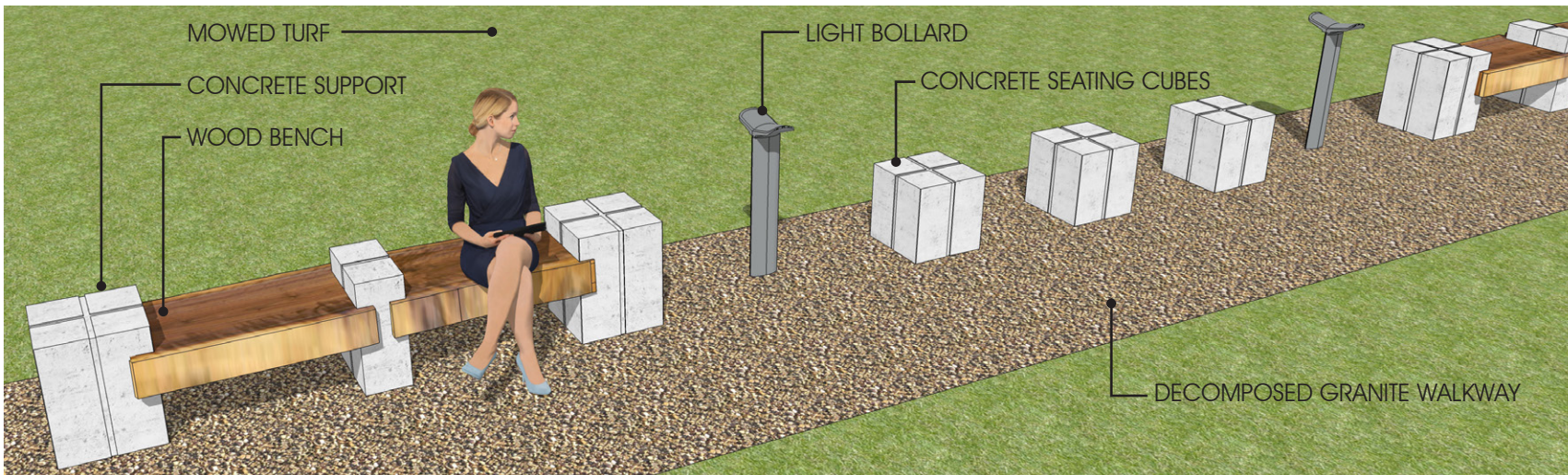

Bench Perspective



Westerly Tree Bosque



Twig Benches

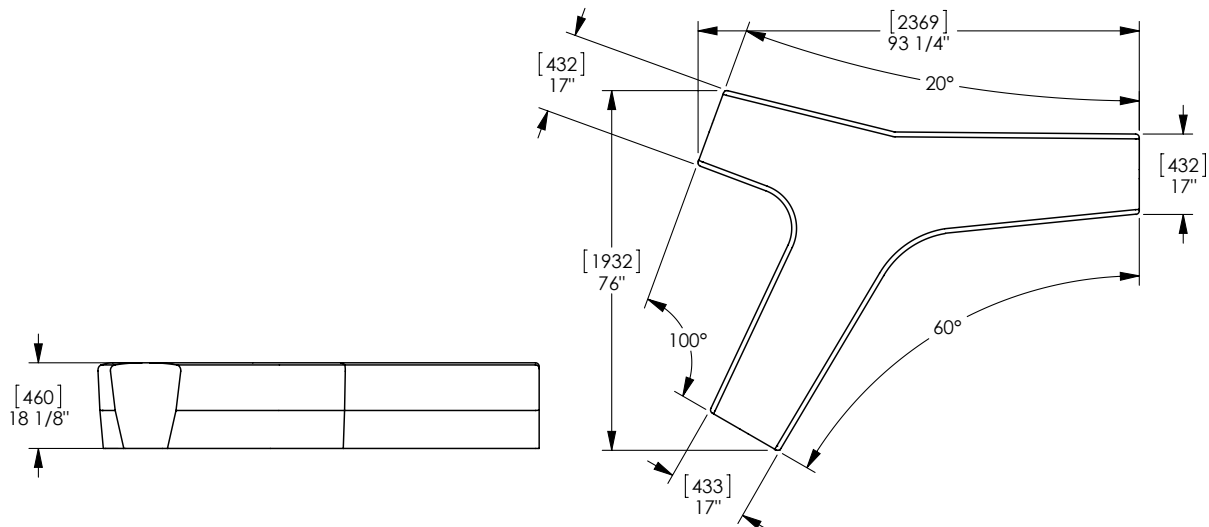

The "twig benches" are used in the westerly bosque of cherry trees where the ground plane has a casual, organic design theme with these irregular shaped benches in a mowed grass planting. The trees are organized in the same geometric triangulated pattern as the easterly bosque.



Path Light / Bollard

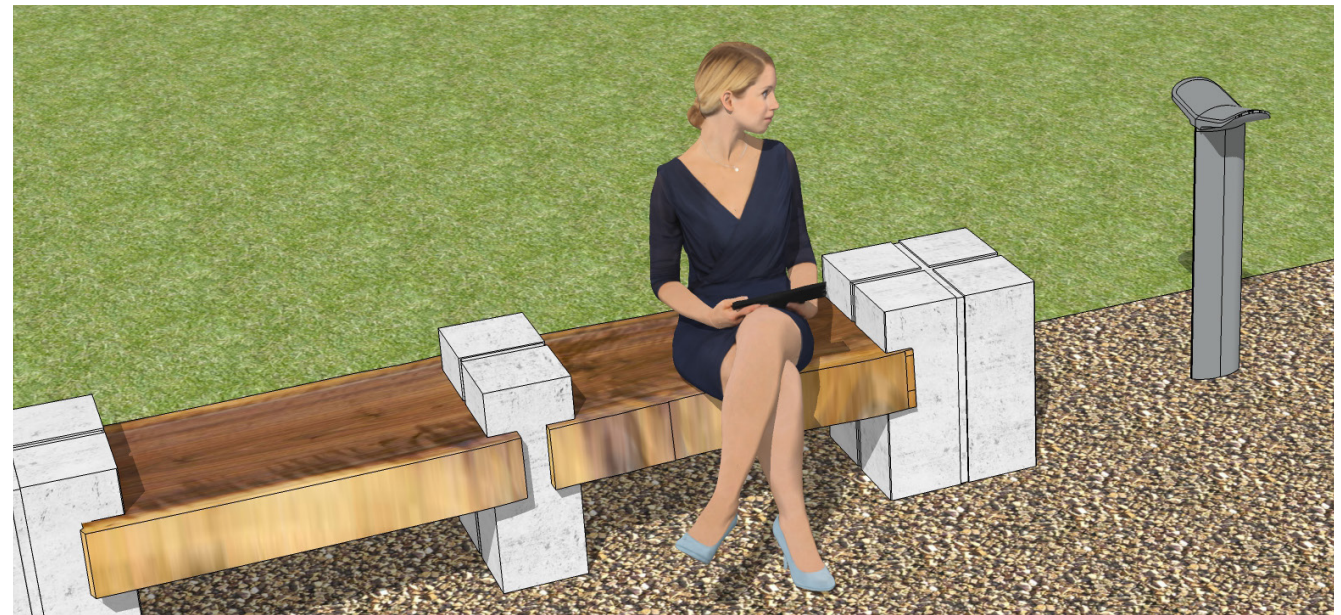
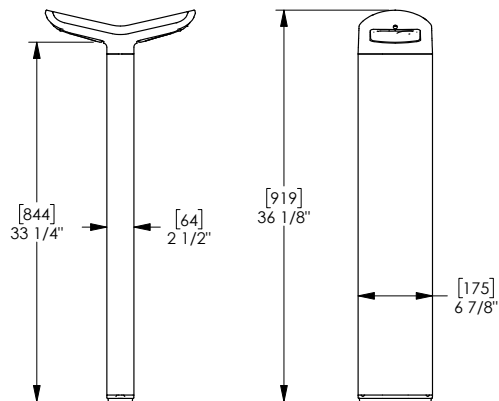
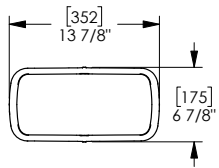

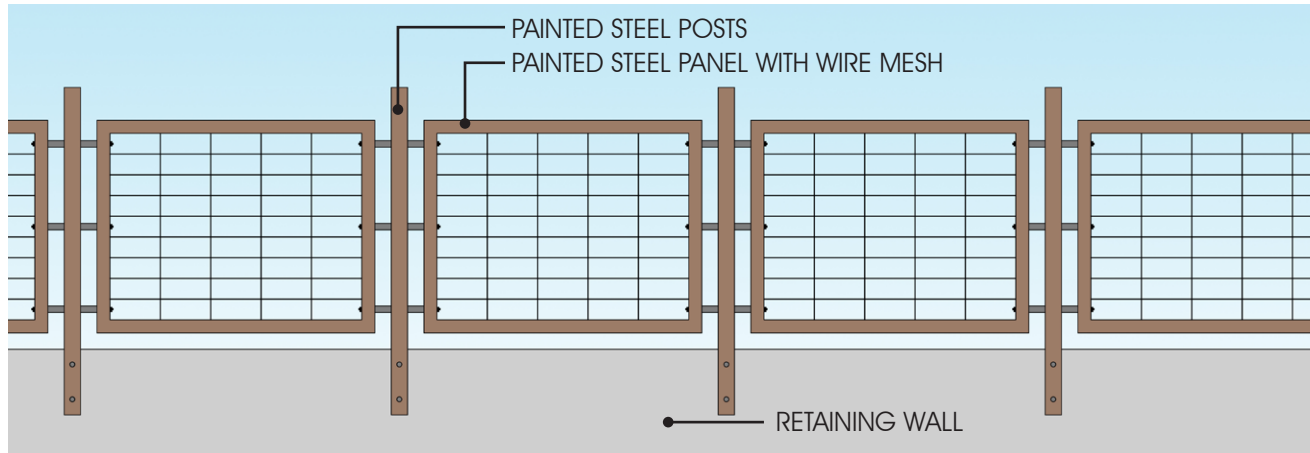

Decorative Railing Elevation

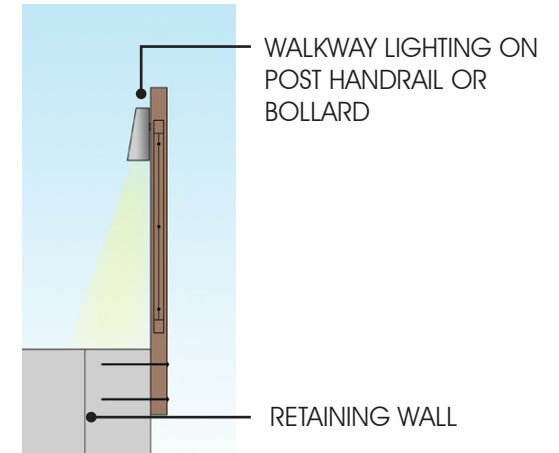

Section

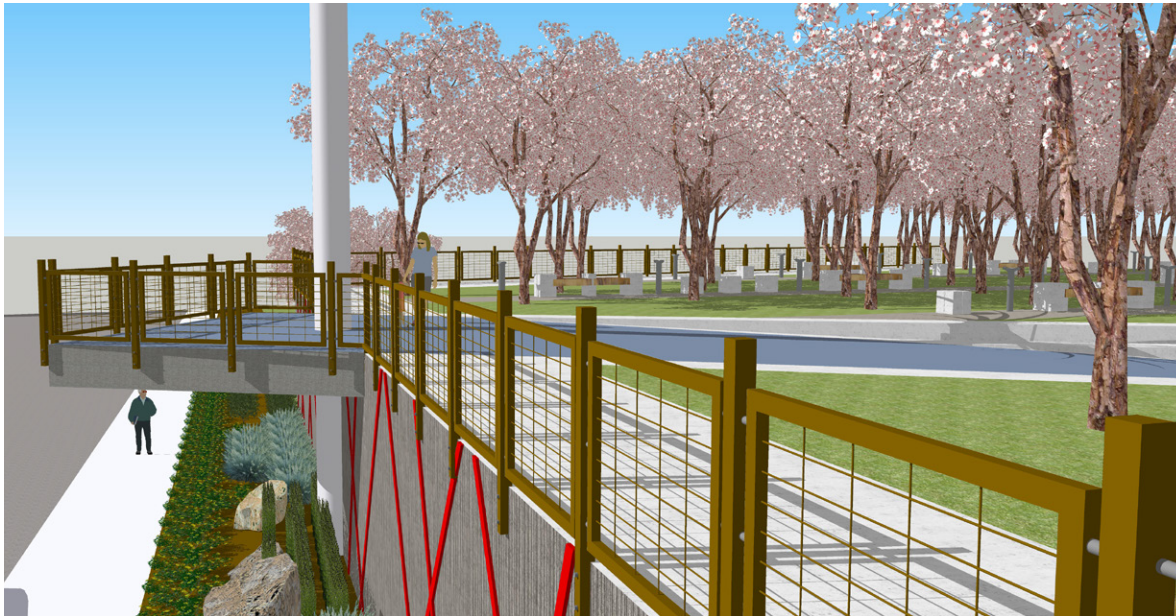

Matsuyama Dori Overlook

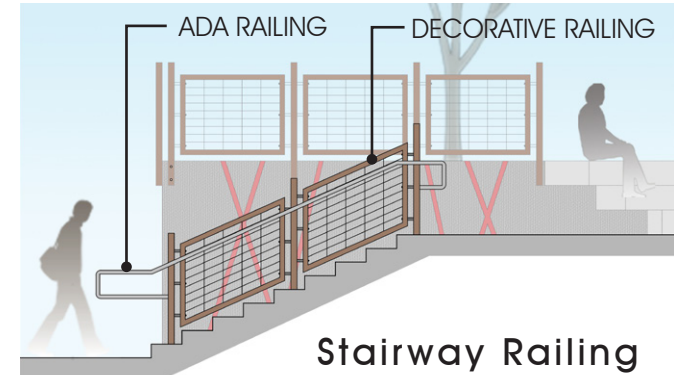

Stairway Railing

The decorative railing is designed to emulate traditional Japanese architectural details while meeting modern building codes for safety. The posts of the railing are mounted on the face of the wall and extend above the top rail creating overlapping vertical and horizontal forms. The fence has a strong presence but is also very transparent allowing views of the cherry trees from Jibboom Street.

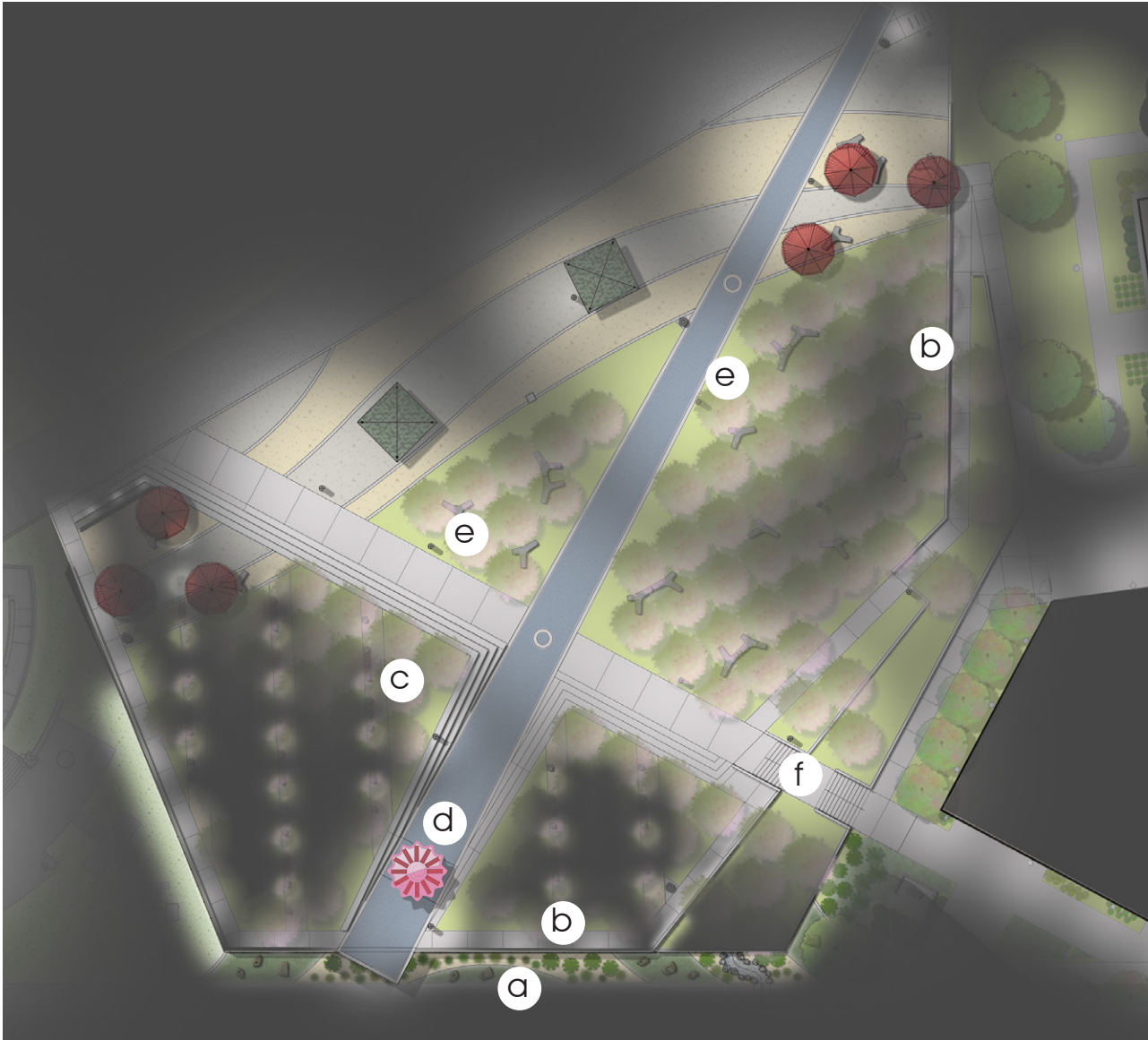

- a. Wall washing along the Jibboom Street retaining wall with accent lights within the origami reveals.
- b. Handrail mounted lights that wash across the perimeter sidewalk.
- c. Bollard style path light that wash across the decomposed granite walkway.
- d. Up-lighting and internal lighting of the tree sculpture, possible color changes based on river flow and / or sister city Matsuyama.
- e. Relocated pole mounted lights from existing park site.
- f. Flush mounted step lighting at stairway.

